

Anglo Fatal Risk Standards

1



Light Vehicles

6



Isolation

2



Surface Mobile Equipment

7



Working @ Heights

0



Underground Equipment

3



Hazardous Materials

8



Lifting Operations

1



Fires & Explosions

4



Molten Materials

9



Underground Control

5



Equipment Safeguarding

AFRS - Isolation

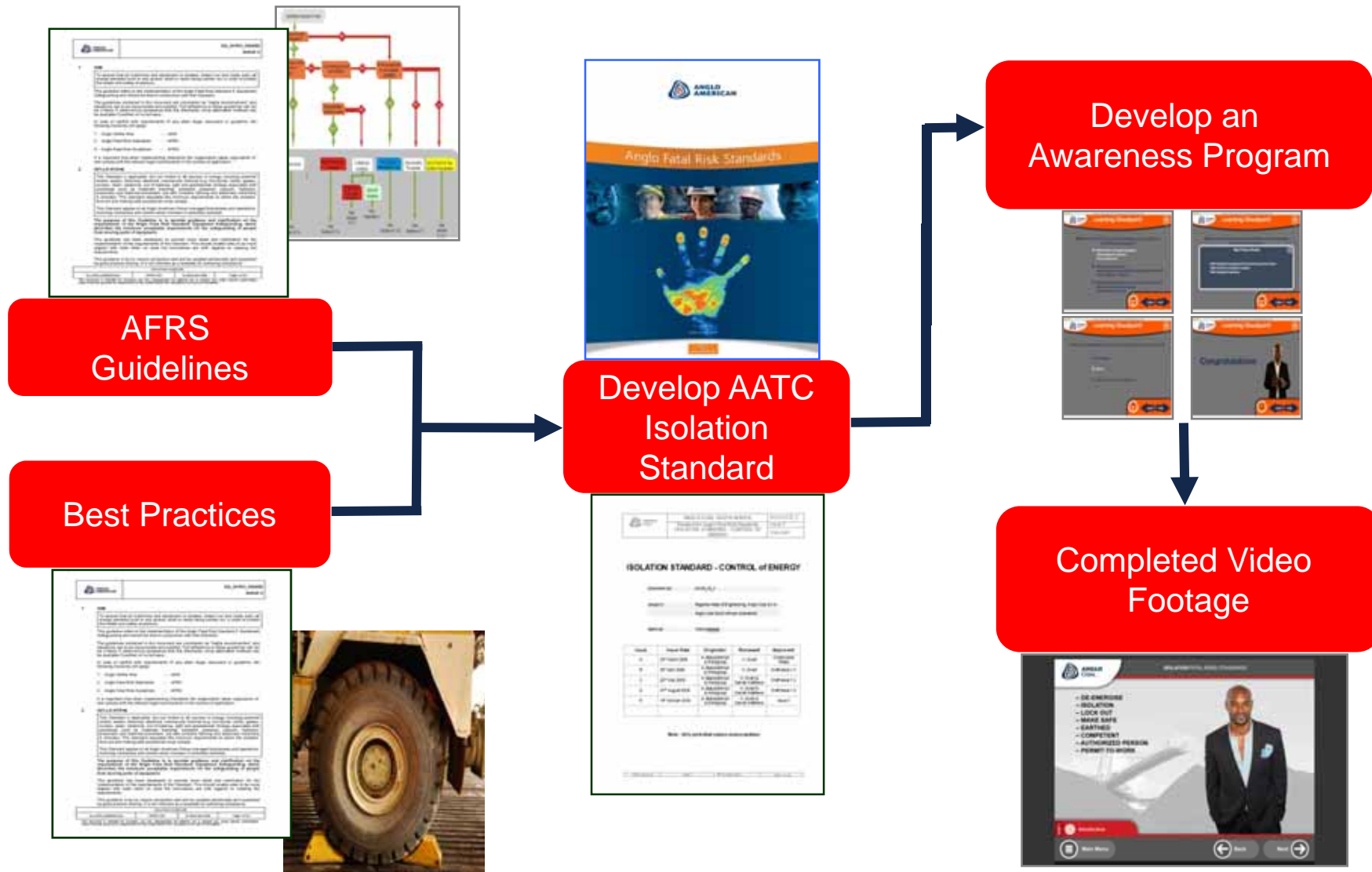

Requirements of Elements



	ANGLO COAL SOUTH AFRICA Standard for Anglo Fatal Risk Standards ISOLATION STANDARD - CONTROL OF ENERGY	ACZAISCE_0 Issue 0 Copyright
	The General Manager of each operation / project shall, on a regular Basis:	
	<ul style="list-style-type: none"> Re-assess the competence of authorized personnel. Audit the lock-out records and Permit to Work documents. Undertake a Risk Assessment on the lock-out procedure. Undertake planned task observations. 	

- Re-assess the competence of authorized personnel.
- Audit the lock-out records and Permit to Work documents.
- Undertake a Risk Assessment on the lock-out procedure.
- Undertake planned task observations.

6.8 PEOPLE REQUIREMENTS

6.8.1 Competency, Training and Authorizations of People

This Standard provides for two categories of persons (refer also to Section 6.3 – Definitions), namely responsible and authorized persons.

All ACZA persons (contractors included) shall as a minimum:

- Undertake the ACZA Isolation Standard Training package, Competency Based Assessment and Awareness program.
- Be tested to perform Isolation, Lockout, Testing, Making Safe and Tag equipment / machinery under his/her control.
- Be responsible to lock out in accordance with this Isolation Standard and Site Specific Procedures.
- Be authorized in writing on specific equipment / machinery being certified for.

	ANGLO COAL SOUTH AFRICA Standard for Anglo Fatal Risk Standards ISOLATION STANDARD - CONTROL OF ENERGY	ACZAISCE_0 Issue 0 Copyright											
	<p>6.7 SYSTEM AND PROCEDURAL REQUIREMENTS</p> <p>6.7.1 Generic 6 Step Isolation Process</p> <p>Where Control of Energy is via isolation, the 6 Step Generic Isolation Process is used.</p>												
	<table border="1"> <tr> <td>Step 1</td> <td>Identify Energy Sources and appropriate Isolation Points.</td> </tr> <tr> <td>Step 2</td> <td>Isolate and Release Energies</td> </tr> <tr> <td>Step 3</td> <td>Test Isolation Effectiveness (Test for Dead & Stored Energy)</td> </tr> <tr> <td>Step 4</td> <td>Apply Locks and Tags</td> </tr> <tr> <td>Step 5</td> <td>Conduct Work</td> </tr> <tr> <td>Step 6</td> <td>Restore</td> </tr> </table>		Step 1	Identify Energy Sources and appropriate Isolation Points.	Step 2	Isolate and Release Energies	Step 3	Test Isolation Effectiveness (Test for Dead & Stored Energy)	Step 4	Apply Locks and Tags	Step 5	Conduct Work	Step 6
Step 1	Identify Energy Sources and appropriate Isolation Points.												
Step 2	Isolate and Release Energies												
Step 3	Test Isolation Effectiveness (Test for Dead & Stored Energy)												
Step 4	Apply Locks and Tags												
Step 5	Conduct Work												
Step 6	Restore												

Different Energy Sources

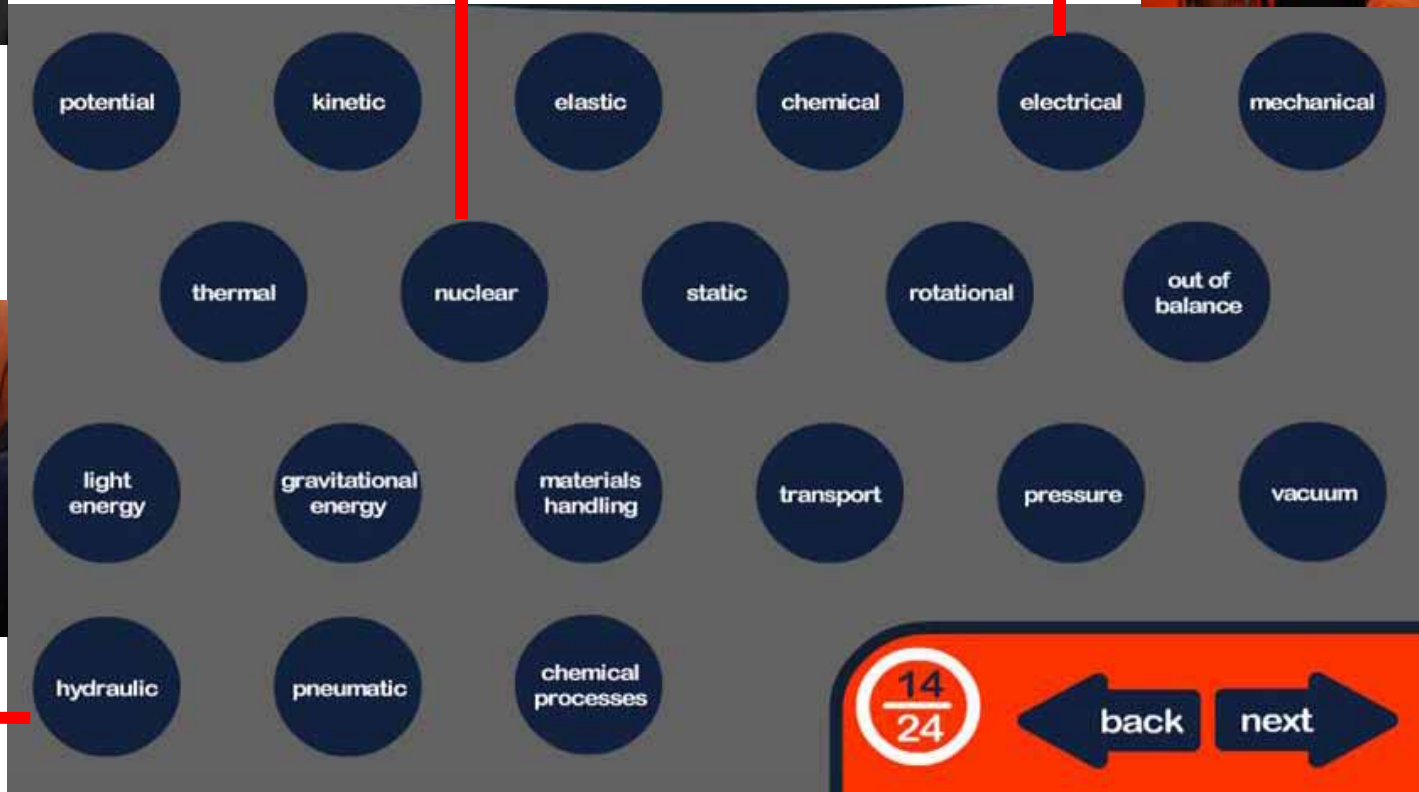

Define & Explain

Potential energy



Energy stored in an object due to its position

Specification Details

Locks

COLOUR CODING

Red	Electrician / Technicians / Engineers /Auto Electricians
Yellow	Process / Mining / Safety
Green	Mechanical / Diesel Mechanics
Orange	Condition Monitoring
Black	All contractors / Temporary
Purple	Lock stations - customized

LASER ENGRAVING

* 3/16" Lettering (Arial font, all caps)

* 1/8" Lettering may only be used if initials and surname is longer than 18 characters

ALL LOCKS

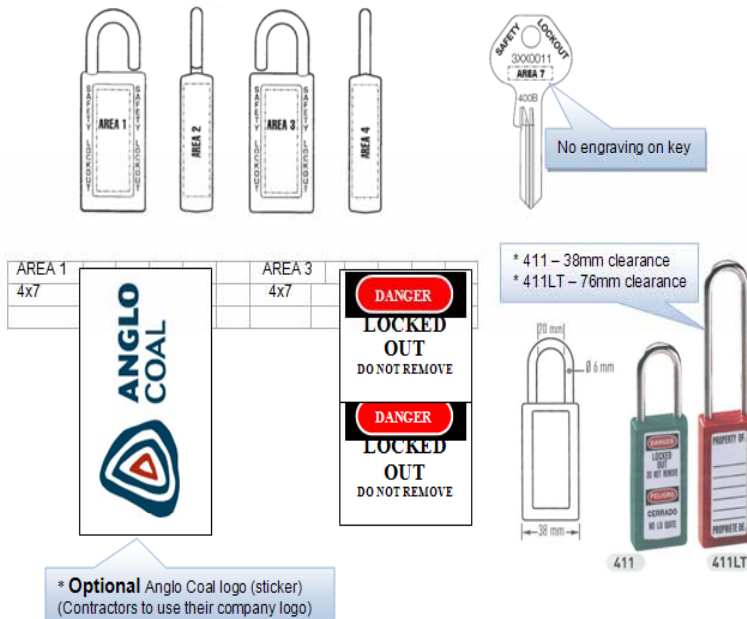

NOTE: Warning notice to be applied on Area 1 or Area 3 for all locks as per above.

PERSONAL LOCKS

AREA 2	G	O	E	D	E	H	O	O	P	* Operation name (Contractors to use company name)
2x18										* Key code (Contractors to utilize Area 3 for the key code or number)
	K	E	Y		C	O	D	E		

AREA 4	C	B		P	R	E	T	O	R	I	U	S	* Initials and Surname * Company no.	
2x18														
	8	6	1	0	0	4	0							
AREA 4	A	B		M	A	S	T	E	R	L	O	C	K	(Contractors to use Initials & Surname or ID Numbers or a padlock registered number which must be recorded in a lock register.)
2x18														
	0	0	7	5										

LOCK STATION LOCKS

AREA 2	G	O	E	D	E	H	O	O	P	* Operation name	
2x18										* Substation name	
	E	X	P	O	R	T		S	U	B	

AREA 4	L	O	C	K		N	O		1	* Lock number
2x18										* Key code
	K	E	Y		C	O	D	E		

TEMPORARY LOCKS

AREA 2	G	O	E	D	E	H	O	O	P	* Operation name	
2x18										* Shaft name	
	H	O	P	E		S	H	A	F	T	

AREA 4	L	O	C	K		N	O		H	O	1	* Lock number
2x18												* Key code
	K	E	Y		C	O	D	E				

Padlock Details

Master lock, 40mm XENOY PADLOCK 6mm SHACKLE 38mm CLEARANCE P/N 411

Master lock, 40mm XENOY PADLOCK 6mm SHACKLE 76mm CLEARANCE P/N 411LT

Specifications – cont.

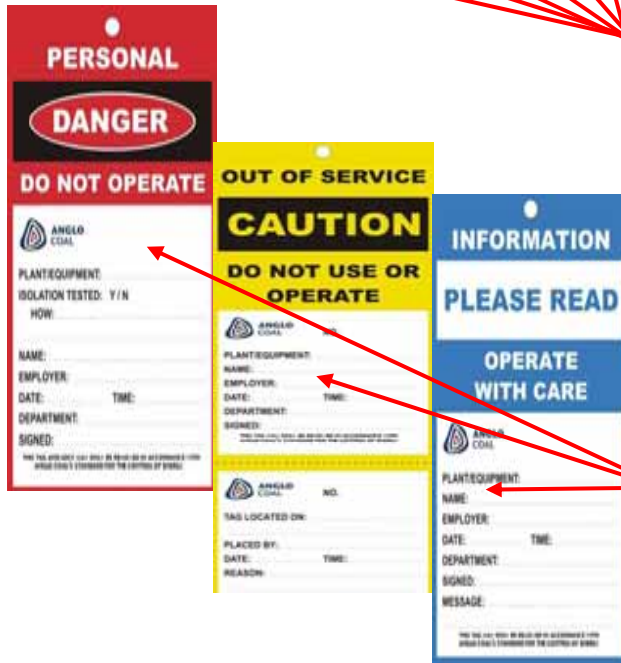

ANGLO AMERICAN CORPORATION SCHEDULE OF PRICES				
Contract Title: Locks and other Safety Lock Out Products				
Contract Number: 76113B001				
Vendor Name: Probe Auto Elect.pty lld div Fawick (cr 001162)				
Vendor Code: 64775A				
Stock Code	Description	Vendor Part No	Delivery Period	Country of origin
761131628	PADLOCK SAFETY KEYED TO DIFFER COLOURORANGE WITH REFERENCE 411 & PERMANENTLYENGRAVED WITH KEY NUMBER AND INFORMATIONAS PER ANGLO COAL SPECIFICATIONS			30 Republic Of South Africa
761131627	PADLOCK SAFETY KEYED TO DIFFER COLOURBLACK WITH REFERENCE 411 & PERMANENTLYENGRAVED WITH KEY NUMBER AND INFORMATIONAS PER ANGLO COAL SPECIFICATIONS			30 Republic Of South Africa
761131628	PADLOCK SAFETY KEYED TO DIFFER COLOURPURPLE WITH REFERENCE 411 & PERMANENTLYENGRAVED WITH KEY NUMBER AND INFORMATIONAS PER ANGLO COAL SPECIFICATIONS			30 Republic Of South Africa
761131629	PADLOCK SAFETY KEYED TO DIFFER COLOURRED WITH REFERENCE 411LT AND PERMANENTLYENGRAVED WITH KEY NUMBER AND INFORMATIONAS PER ANGLO COAL SPECIFICATIONS			30 Republic Of South Africa
761131630	PADLOCK SAFETY KEYED TO DIFFER COLOURYELLOW W REFERENCE 411LT & PERMANENTLYENGRAVED WITH KEY NUMBER AND INFORMATIONAS PER ANGLO COAL SPECIFICATIONS			30 Republic Of South Africa
761131631	PADLOCK SAFETY KEYED TO DIFFER COLOURGREEN WITH REFERENCE 411LT & PERMANENTLYENGRAVED WITH KEY NUMBER AND INFORMATIONAS PER ANGLO COAL SPECIFICATIONS			30 Republic Of South Africa
761131632	PADLOCK SAFETY KEYED TO DIFFER COLOURORANGE W REFERENCE 411LT & PERMANENTLYENGRAVED WITH KEY NUMBER AND INFORMATIONAS PER ANGLO COAL SPECIFICATIONS			30 Republic Of South Africa
761131633	PADLOCK SAFETY KEYED TO DIFFER COLOURBLACK W REFERENCE 411LT & PERMANENTLYENGRAVED WITH KEY NUMBER AND INFORMATIONAS PER ANGLO COAL SPECIFICATIONS			30 Republic Of South Africa
761131634	PADLOCK SAFETY KEYED TO DIFFER COLOURPURPLE W REFERENCE 411LT & PERMANENTLYENGRAVED WITH KEY NUMBER AND INFORMATIONAS PER ANGLO COAL SPECIFICATIONS			30 Republic Of South Africa
77721	Labels, Tickets and Tags			
5011 - 6098	Labels, Tie-Off, Other			
777216051	TAG RED PERSONAL DANGER DO NOT OPERATEFOR LOCKOUT SYSTEMS PRINTED AS PERANGLO COAL SPECIFICATION			30 Republic Of South Africa
777216052	TAG YELLOW OUT OF SERVICE CAUTION DONOT USE OR OPERATE FOR LOCKOUT SYSTEMSPRINTED AS PER ANGLO COAL SPECIFICATION			30 Republic Of South Africa
777216053	TAG BLUE INFORMATION PLEASE READOPERATE WITH CARE FOR LOCKOUT SYSTEMSPRINTED AS PER ANGLO COAL SPECIFICATION			30 Republic Of South Africa

Applications



Aim and Application



10
24



Personal Locking Devices

L D



L T K



P C H



L S



Lock & Tag Applications

P _____ I _____



R _____ K _____



T _____ K _____



O _____ I _____



Group Isolation Process - start

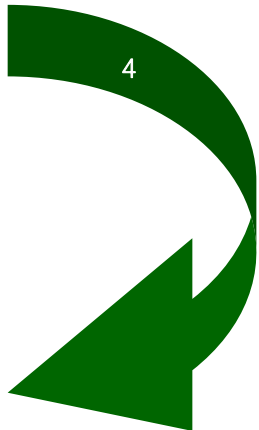

**Work
Commences**



Group Isolation Process - completion

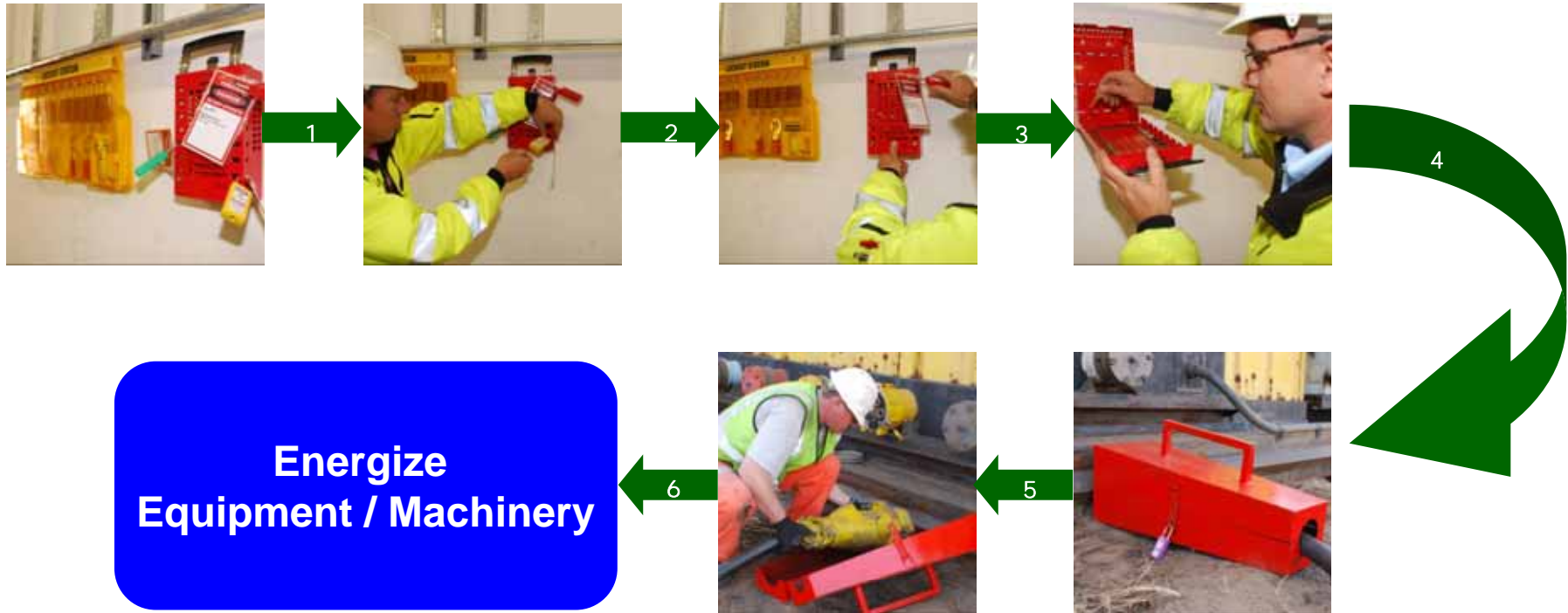

Definition

ANGLO COAL

Definitions

OPERATOR

COMPETENT PERSON

AUTHORISED PERSON

RESPONSIBLE SUPERVISOR

DE-ENERGISE

ISOLATION

LOCK OUT

MAKE SAFE

EARTHED

PERMIT TO WORK

16 / 24

back next

Defined

1. OPERATOR



Operator means the person in charge of the operation of some specific equipment or machinery

Procedural



Requirements



Plant & Equipment Requirements

The screenshot shows a mobile application interface with a red header bar. On the left of the header is the Anglo Coal logo, and on the right is a close button (a white 'X' in a circle). The main content area is grey and contains five dark blue circular buttons arranged horizontally, labeled 'Equipment', 'Isolation', 'Locking Devices', 'Isolation Points', and 'Isolation Tagging'. At the bottom right, there is a red navigation bar containing a circular progress indicator showing '19' over '24', a 'back' button with a left-pointing arrow, and a 'next' button with a right-pointing arrow.

Details of Requirements

1. Equipment



All equipment whether purchased or constructed, shall have the capability of being isolated physically from all energy sources as required and meets the requirements of this Standard.

People



People Requirements



Competency Assessment



Learning Checkpoint



From the list name four sources of energy

A. Chemical - Kinetic - Electrical - Mechanical

B. Electrical – Mechanical – Torsion – Physical

C. Mechanical – Kinetic – Muscular – Electronic



Continue – CBA



Learning Checkpoint



From the list name three definitions:

- A. Permit-to-work – Mine manager – face boss
- B. Isolation – pit superintendent – mine overseer
- C. Isolation - Lock-Out - Make Safe

